

Unpacking

Before you begin using the device, please check that the following items are included in the shipped box:

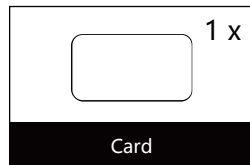

Product Overview

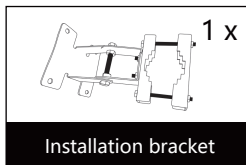
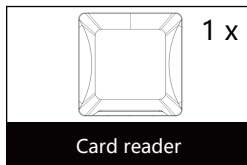

Status Light

Before You Start

Installation Recommendation

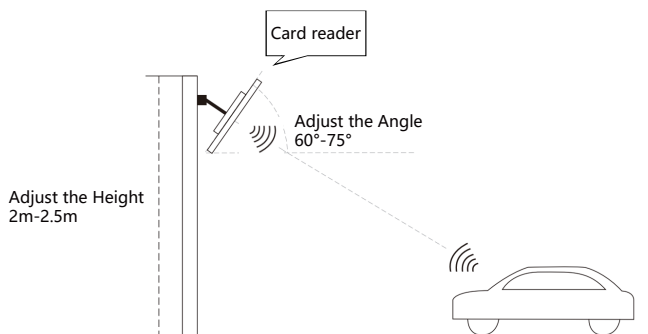

Note:

The recommended installation height and angle are provided for reference only. Please adjust the device installation according to the specific requirements of your application scenario.

Power Specification

- It is recommended to use a linear DC power supply. The power supply distance should not exceed 100 meters; if it does, use a separate power source.
- The input power should be within 12V \pm 10% to ensure the device operates correctly.

Requirements

- It is recommended to keep at least 30 cm between devices.
- To reduce long-distance interference, ensure the shielding of the transmission cable is grounded with the device.

Warning!

- 1.To ensure safety, avoid touching power cord, power adapter, and device with wet hands, bending or pulling the power cord, damaging any components, and use only qualified power adapter and power cord.
- 2.Be careful that standing up on the area under the device in case of personal injuries caused by hitting the device.

Caution

- 1.Do not knock device with hard objects.
- 2.Do not expose device to chemical products, such as alcohol, acid liquid, disinfectants, and so on.
- 3.To prevent the device installation from becoming loose, ensure accurate diameters and depths of screw holes. If the screw holes are too large, use glue to secure the screws.
- 4.Use wet cloth clean device surface softly, and then wipe the surface with dry cloth for cleaning the device.
- 5.If there is abnormal situation of the device, including uncommon sound and smell, please power off the device and contact Akuvox Technical Team immediately.

Installation

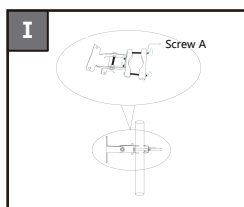

All screws are pre-installed on the bracket.
Please follow the steps below to secure bracket and card reader.

Bracket Mounting

- Slide the bracket's hole over the pole.
- Tighten the four **Screw A** to secure the bracket to the pole.

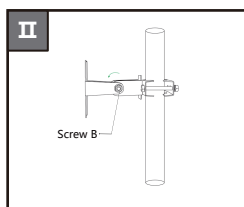

Bracket Angle Adjustment

- Adjust the bracket angle as needed, then tighten the two **Screw B** to lock the angle in place.

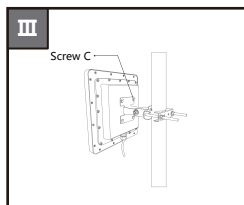

Card Reader Mounting

- Removed the four pre-installed **Screw C** from the back of device.
- Attach the device to the installation bracket by tightening the four Screw C into the holes on the back of the device.

Device Status Information

Device Status	Description
Buzzer beep once, green light flash once	Card read successfully
Red light always on	Normal

Application Network Topology

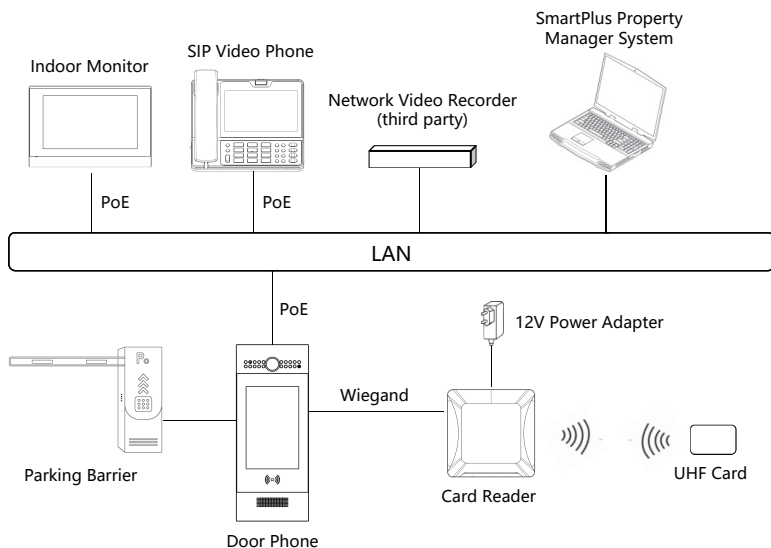

Device Test

To test the card reader functionality, you can use the card provided in the box. Ensure the necessary wiring is connected before testing.

1. **Power on:** Power on the device. The status light will turn red and the buzzer will beep once, indicating the device has successfully started.
2. **Unlock:** Add and swipe the card. The status will turn green and the buzzer will beep once, indicating a successful unlock.

Warranty

1. Akuvox warranty does not cover intentional mechanical damage or destruction caused by improper installation.
2. Do not attempt to modify, alternate, maintain, or repair device by yourself. Akuvox warranty does not apply to damages caused by anyone who is not representative of Akuvox or an Akuvox authorized service provider. Please contact Akuvox Technical Team if the device need to be repaired.

Get Help

For help or more assistance, contact us at:



<https://ticket.akuvox.com/>



support@akuvox.com



Scan the QR code to get more videos, guides, and additional product information.

Notice Information

Information contained in this document is believed to be accurate and reliable at the time of printing. This document is subject to change without notice, any update to this document can be viewed on Akuvox' s website: <https://www.akuvox.com> © Copyright 2024 Akuvox Ltd. All rights reserved.

